

Attachment 1 Proposal for Polish Pioneers Foundation Public Art Installation (Kings Park) Total pages=19

REVISION

No	DATE	DESCRIPTION	BY	CHECK
A	16/08/16	DEVELOPMENT APPLICATION	mb	mb

NOTE:
 ARCHITECT: MICHAEL BERNACKI (929)
 ACCREDITATION NUMBER: CC6490
 LAND TITLE REF NUMBER: KINGS PARK
 SOIL CLASSIFICATION: NA
 CLIMATE ZONE: 7
 BAL: LOW
 ALPINE AREA: N/A
 CORROSION ENVIRONMENT: N/A
 FLOODING: NO
 LANDSLIP: NO
 DISPERSIVE SOILS: UNKNOWN
 SALINE SOILS: UNKNOWN
 SAND DUNES: NO
 MINE SUBSIDENCE: NO
 LANDFILL: NO
 GROUND LEVELS: REFER PLAN

NOTE:
 ALL ERRORS OR ANOMALIES ARE TO BE REPORTED TO HONED ARCHITECTURE + DESIGN.
 DO NOT SCALE OF DRAWINGS.
 CONFIRM ALL SIZES AND HEIGHTS ON SITE.
 ALL CONSTRUCTION IS TO COMPLY WITH BUILDING CODE OF AUSTRALIA AND AUSTRALIAN STANDARDS.
 THESE DOCUMENTS ARE INTENDED FOR COUNCIL PLANNING APPLICATIONS ONLY AND ARE NOT INTENDED FOR ANY OTHER PURPOSE



NOTE: THESE DRAWINGS ARE FOR DEVELOPMENT APPLICATION

DEVELOPMENT APPLICATION POLISH PIONEERS FOUNDATION PUBLIC ART INSTALLATION (KINGS PARK) LAUNCESTON, TASMANIA



PO BOX 147, LAUNCESTON,
 TASMANIA 7250 Ph: 0417541646
 DIMENSIONS ARE SUBJECT TO SITE MEASUREMENT & VERIFICATION DO NOT SCALE OFF THIS DRAWING
 ALL DESIGNS ARE COPYRIGHT AND REMAIN PROPERTY OF HONED ARCHITECTURE + DESIGN.

PROJECT NAME:
 POLISH PIONEERS FOUNDATION
 PUBLIC ART INSTALLATION

DRAWING TITLE:
 COVER SHEET

DRAWING No.	DRAWING TITLE
A-BA-01	Cover Sheet
A-BA-02	History of the Polish Pioneers
A-BA-03	Project Objectives
A-BA-04	Site Plan
A-BA-05	Proposed Perspective Montage - Sheet 1
A-BA-06	Proposed Perspective Montage - Sheet 2
A-BA-07	Proposed Perspective Montage - Sheet 3
A-BA-08	Proposed Perspective Montage - Sheet 4
A-BA-09	Proposed Night Perspective Montage - Sheet 5
A-BA-10	Proposed Plan
A-BA-11	Setout Plan
A-BA-12	Concrete Cut Line Plan
A-BA-13	Floor Finishes Plan
A-BA-14	Electrical Plan
A-BA-15	Northern and Eastern Elevations
A-BA-16	Southern and Western Elevations
A-BA-17	Sections A, B & C
A-BA-18	Construction Details
A-BA-19	Signage Details

DRAWN: MB
 CHECKED: MB

SCALE: NTS @ A3
 DATE: SEPTEMBER_2015
 PROJECT NO. 1527
 DRAWING NO. A-DA-01 A



In October 1947 the first group of 280 Polish ex-servicemen – the so called “Rats of Tobruk” from the Carpathian Brigade – came to the Hydro-Electric Commission’s construction camps in central Tasmania to start work. It was the first organised group of non-British migrants contracted and sponsored by the Australian Government. This group was followed by others, ex-servicemen as well as civilian Polish settlers, mostly refugees from England and Germany.

The choice of Polish soldiers as the first Government sponsored group of non-British migrants was not accidental. Many friendships were forged when the Poles fought alongside Australians during the African campaign and the Polish soldiers, particularly the Carpathian Brigade, were known for their courage and discipline.

Over 800 Polish men arrived in 1947-48 in Tasmania. The majority of them spent two years working in isolated construction camps at Tarraleah, Bronte Park, Butlers Gorge, Waddamana, Poatina, Trevallyn Dam, Wayatinah and Liawenee. They worked 44 hours per week, in very rough weather conditions, living initially in provisional barracks with primitive facilities. In some of the camps, Polish rather than English was the main language of communication.

After completing their work contracts, most of the ex-servicemen stayed with the H.E.C. and while some remained in the camps, the majority moved to Hobart or Launceston. There was a great sense of camaraderie among the Poles. The ex-servicemen formed the Association of the Carpathian Brigade ex-Servicemen and the Association of the Polish Veterans.

It was also the early migrants who became leaders and activists of the Polish community. They played the key role in establishing the Polish Association (in 1950), Polish Club (1961), Polish Credit Union, Polish School (1954), Polish Scouting Troop (1971), White Eagle sport club (1961), club “Oberek” dancing ensemble (1952) and the radio program. The Polish Ladies Auxiliary (1963), Senior’s Club (1977) and Polish Welfare Office (1990’s) were later established to help the frail and ageing.

In the 2011 census more than 3300 Tasmanians claimed Polish ancestry and nearly 1000 of those stated that both their parents were born in Australia. Most Polish groups are headed now by the children of the post war migrants. The vitality of these groups has enriched the entire Tasmanian community and is the most important legacy of Polish post-war immigration.

REVISION			
No	DATE	DESCRIPTION	BY CHECK
A	16/08/16	DEVELOPMENT APPLICATION	mb mb

NOTE:
 ALL ERRORS OR ANOMALIES ARE TO BE REPORTED TO HONED ARCHITECTURE + DESIGN
 DO NOT SCALE OF DRAWINGS.
 CONFIRM ALL SIZES AND HEIGHTS ON SITE.
 ALL CONSTRUCTION IS TO COMPLY WITH BUILDING CODE OF AUSTRALIA AND AUSTRALIAN STANDARDS.
 THESE DOCUMENTS ARE INTENDED FOR COUNCIL PLANNING APPLICATIONS ONLY AND ARE NOT INTENDED FOR ANY OTHER PURPOSE.

DEVELOPMENT APPLICATION
 NOT FOR CONSTRUCTION

NOTE: THESE DRAWINGS ARE FOR DEVELOPMENT APPLICATION



PO BOX 147, LAUNCESTON, TASMANIA 7250 Ph: 0417541646

DIMENSIONS ARE SUBJECT TO SITE MEASUREMENT & VERIFICATION DO NOT SCALE OFF THIS DRAWING ALL DESIGNS ARE COPYRIGHT AND REMAIN PROPERTY OF HONED ARCHITECTURE + DESIGN.

PROJECT NAME:
 POLISH PIONEERS FOUNDATION
 PUBLIC ART INSTALLATION

DRAWING TITLE:
 HISTORY OF THE
 POLISH PIONEERS

DRAWN: MB
 CHECKED: MB

SCALE: NTS @ A3
 DATE: SEPTEMBER_2015
 PROJECT NO. 1527
 DRAWING NO. A-DA-02 A

THE OBJECTIVES:

- EDUCATES THE YOUNGER GENERATIONS IN POLISH MIGRANT HISTORY
- CREATES AWARENESS OF THE INVOLVEMENT THE POLISH COMMUNITY HAD TO THE TASMANIA POWER SCHEMES
- ACKNOWLEDGES THE POLISH PIONEERS AND THE FOUNDATION CREATED
- CREATES A PLACE TO GATHER AND REFLECT TASMANIA'S POLISH HISTORY
- CREATES INTERACTION WITHIN THE COMMUNITY
- INSTILLS PUBLIC ART INTO THE COMMUNITY
- EXPRESS COMMUNITY VALUES
- HEIGHTENS OUR AWARENESS TO EUROPEAN HISTORY
- ENHANCE OUR BUILDING / LANDSCAPE ENVIRONMENT
- CREATES COMMUNITY INVOLVEMENT
- ENCOURAGES COMMUNITY INTERACTION
- THE CREATION AND BEGINNING OF MIGRANT WAY

REVISION

No	DATE	DESCRIPTION	BY	CHECK
A	16/08/16	DEVELOPMENT APPLICATION	mb	mb

NOTE:
 ALL ERRORS OR ANOMALIES ARE TO BE REPORTED TO HONED ARCHITECTURE + DESIGN.
 DO NOT SCALE OF DRAWINGS.
 CONFIRM ALL SIZES AND HEIGHTS ON SITE.
 ALL CONSTRUCTION IS TO COMPLY WITH BUILDING CODE OF AUSTRALIA AND AUSTRALIAN STANDARDS.
 THESE DOCUMENTS ARE INTENDED FOR COUNCIL PLANNING APPLICATIONS ONLY AND ARE NOT INTENDED FOR ANY OTHER PURPOSE



NOTE: THESE DRAWINGS ARE FOR DEVELOPMENT APPLICATION



PO BOX 147, LAUNCESTON, TASMANIA 7250 Ph: 0417541646
 DIMENSIONS ARE SUBJECT TO SITE MEASUREMENT & VERIFICATION DO NOT SCALE OFF THIS DRAWING
 ALL DESIGNS ARE COPYRIGHT AND REMAIN PROPERTY OF HONED ARCHITECTURE + DESIGN.

PROJECT NAME:
 POLISH PIONEERS FOUNDATION
 PUBLIC ART INSTALLATION

DRAWING TITLE:
 PROJECT OBJECTIVES

DRAWN: MB
 CHECKED: MB

SCALE: NTS @ A3

DATE: SEPTEMBER 2015

PROJECT NO. 1527

DRAWING NO. A-DA-03 A



REVISION

No	DATE	DESCRIPTION	BY	CHECK
A	16/08/16	DEVELOPMENT APPLICATION	mb	mb

NOTE:

ALL ERRORS OR ANOMALIES ARE TO BE REPORTED TO HONED ARCHITECTURE + DESIGN

DO NOT SCALE OF DRAWINGS

CONFIRM ALL SIZES AND HEIGHTS ON SITE

ALL CONSTRUCTION IS TO COMPLY WITH BUILDING CODE OF AUSTRALIA AND AUSTRALIAN STANDARDS.

THESE DOCUMENTS ARE INTENDED FOR COUNCIL PLANNING APPLICATIONS ONLY AND ARE NOT INTENDED FOR ANY OTHER PURPOSE

DEVELOPMENT APPLICATION
NOT FOR CONSTRUCTION

NOTE: THESE DRAWINGS ARE FOR DEVELOPMENT APPLICATION



PO BOX 147, LAUNCESTON, TASMANIA 7250 Ph: 0417541646

DIMENSIONS ARE SUBJECT TO SITE MEASUREMENT & VERIFICATION DO NOT SCALE OFF THIS DRAWING ALL DESIGNS ARE COPYRIGHT AND REMAIN PROPERTY OF HONED ARCHITECTURE + DESIGN.

PROJECT NAME:

POLISH PIONEERS FOUNDATION
PUBLIC ART INSTALLATION

DRAWING TITLE:

SITE PLAN

DRAWN: MB

CHECKED: MB

SCALE: NTS @ A3

DATE: SEPTEMBER_2015

PROJECT NO. 1527

DRAWING NO. A-DA-04

A





VIEW FROM STILL WATER



VIEW FROM LAUNCETSON YACHT CLUB

REVISION

No	DATE	DESCRIPTION	BY	CHECK
A	16/08/16	DEVELOPMENT APPLICATION	mb	mb

NOTE:

ALL ERRORS OR ANOMALIES ARE TO BE REPORTED TO HONED ARCHITECTURE + DESIGN.

DO NOT SCALE OF DRAWINGS.

CONFIRM ALL SIZES AND HEIGHTS ON SITE.

ALL CONSTRUCTION IS TO COMPLY WITH BUILDING CODE OF AUSTRALIA AND AUSTRALIAN STANDARDS.

THESE DOCUMENTS ARE INTENDED FOR COUNCIL PLANNING APPLICATIONS ONLY AND ARE NOT INTENDED FOR ANY OTHER PURPOSE.

DEVELOPMENT APPLICATION
NOT FOR CONSTRUCTION

NOTE: THESE DRAWINGS ARE FOR DEVELOPMENT APPLICATION



PO BOX 147, LAUNCESTON, TASMANIA 7250 Ph: 0417541646
DIMENSIONS ARE SUBJECT TO SITE MEASUREMENT & VERIFICATION DO NOT SCALE OFF THIS DRAWING
ALL DESIGNS ARE COPYRIGHT AND REMAIN PROPERTY OF HONED ARCHITECTURE + DESIGN.

PROJECT NAME:
POLISH PIONEERS FOUNDATION PUBLIC ART INSTALLATION

DRAWING TITLE:
PROPOSED PERSPECTIVE MONTAGE SHEET 1

DRAWN: MB
CHECKED: MB

SCALE: NTS @ A3
DATE: SEPTEMBER 2015
PROJECT NO. 1527
DRAWING NO. A-DA-05 A



EASTERN ELEVATION



WESTERN ELEVATION

REVISION

No	DATE	DESCRIPTION	BY	CHECK
A	16/08/16	DEVELOPMENT APPLICATION	mb	mb

NOTE:
 ALL ERRORS OR ANOMALIES ARE TO BE REPORTED TO HONED ARCHITECTURE + DESIGN
 DO NOT SCALE OF DRAWINGS.
 CONFIRM ALL SIZES AND HEIGHTS ON SITE.
 ALL CONSTRUCTION IS TO COMPLY WITH BUILDING CODE OF AUSTRALIA AND AUSTRALIAN STANDARDS.
 THESE DOCUMENTS ARE INTENDED FOR COUNCIL PLANNING APPLICATIONS ONLY AND ARE NOT INTENDED FOR ANY OTHER PURPOSE

DEVELOPMENT APPLICATION
 NOT FOR CONSTRUCTION

NOTE: THESE DRAWINGS ARE FOR DEVELOPMENT APPLICATION



PO BOX 147, LAUNCESTON, TASMANIA 7250 Ph: 0417541646

DIMENSIONS ARE SUBJECT TO SITE MEASUREMENT & VERIFICATION DO NOT SCALE OFF THIS DRAWING ALL DESIGNS ARE COPYRIGHT AND REMAIN PROPERTY OF HONED ARCHITECTURE + DESIGN.

PROJECT NAME:
 POLISH PIONEERS FOUNDATION PUBLIC ART INSTALLATION

DRAWING TITLE:
 PROPOSED PERSPECTIVE MONTAGE SHEET 2

DRAWN: MB
 CHECKED: MB

SCALE: NTS @ A3
 DATE: SEPTEMBER_2015
 PROJECT NO. 1527
 DRAWING NO. A-DA-06 A



SOUTHERN ELEVATION

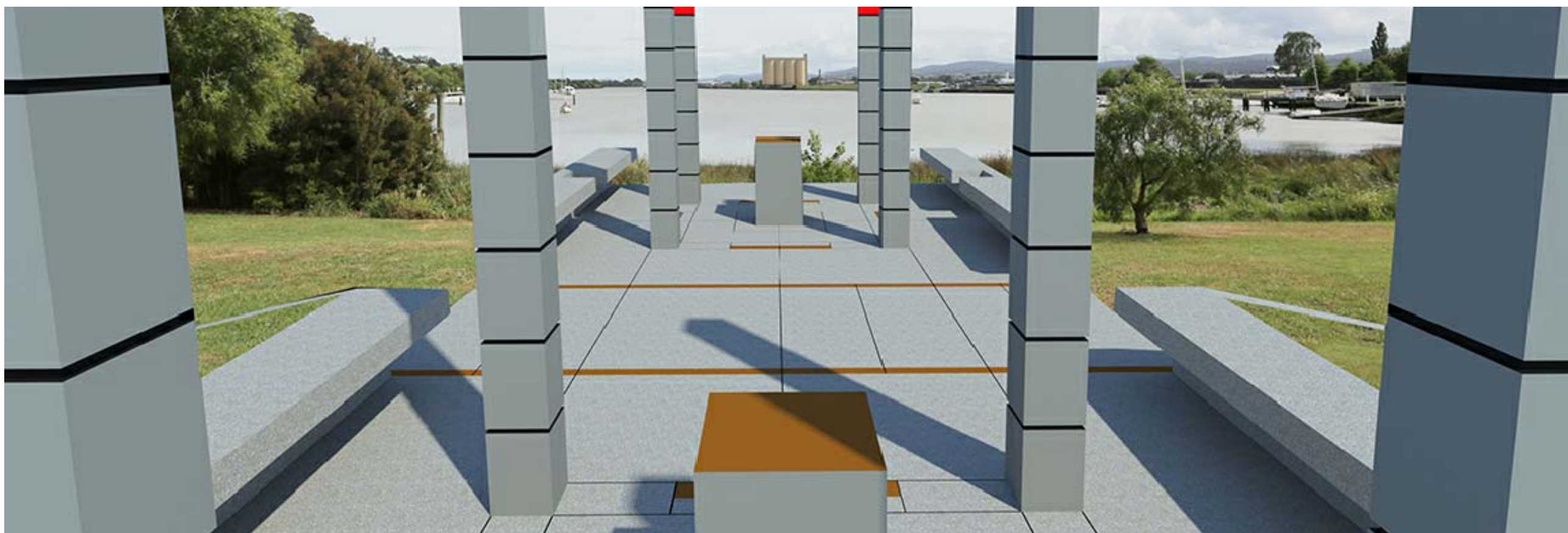

VIEW UP THE TAMAR RIVER

REVISION

No	DATE	DESCRIPTION	BY	CHECK
A	16/08/16	DEVELOPMENT APPLICATION	mb	mb

NOTE:

ALL ERRORS OR ANOMALIES ARE TO BE REPORTED TO HONED ARCHITECTURE + DESIGN.

DO NOT SCALE OF DRAWINGS.

CONFIRM ALL SIZES AND HEIGHTS ON SITE.

ALL CONSTRUCTION IS TO COMPLY WITH BUILDING CODE OF AUSTRALIA AND AUSTRALIAN STANDARDS.

THESE DOCUMENTS ARE INTENDED FOR COUNCIL PLANNING APPLICATIONS ONLY AND ARE NOT INTENDED FOR ANY OTHER PURPOSE.

DEVELOPMENT APPLICATION
NOT FOR CONSTRUCTION

NOTE: THESE DRAWINGS ARE FOR DEVELOPMENT APPLICATION



PO BOX 147, LAUNCESTON, TASMANIA 7250 Ph: 0417541646
DIMENSIONS ARE SUBJECT TO SITE MEASUREMENT & VERIFICATION DO NOT SCALE OFF THIS DRAWING
ALL DESIGNS ARE COPYRIGHT AND REMAIN PROPERTY OF HONED ARCHITECTURE + DESIGN.

PROJECT NAME:
POLISH PIONEERS FOUNDATION PUBLIC ART INSTALLATION

DRAWING TITLE:
PROPOSED PERSPECTIVE MONTAGE SHEET 3

DRAWN: MB
CHECKED: MB

SCALE: NTS @ A3
DATE: SEPTEMBER 2015

PROJECT NO. 1527
DRAWING NO. A-DA-07 A

REVISION

No	DATE	DESCRIPTION	BY	CHECK
A	16/08/16	DEVELOPMENT APPLICATION	mb	mb

NOTE:

ALL ERRORS OR ANOMALIES ARE TO BE REPORTED TO HONED ARCHITECTURE + DESIGN.

DO NOT SCALE OF DRAWINGS.

CONFIRM ALL SIZES AND HEIGHTS ON SITE.

ALL CONSTRUCTION IS TO COMPLY WITH BUILDING CODE OF AUSTRALIA AND AUSTRALIAN STANDARDS.

THESE DOCUMENTS ARE INTENDED FOR COUNCIL PLANNING APPLICATIONS ONLY AND ARE NOT INTENDED FOR ANY OTHER PURPOSE.

DEVELOPMENT APPLICATION
NOT FOR CONSTRUCTION

NOTE: THESE DRAWINGS ARE FOR DEVELOPMENT APPLICATION



PO BOX 147, LAUNCESTON, TASMANIA 7250 Ph: 0417541646

DIMENSIONS ARE SUBJECT TO SITE MEASUREMENT & VERIFICATION DO NOT SCALE OFF THIS DRAWING ALL DESIGNS ARE COPYRIGHT AND REMAIN PROPERTY OF HONED ARCHITECTURE + DESIGN.

PROJECT NAME:

POLISH PIONEERS FOUNDATION PUBLIC ART INSTALLATION

DRAWING TITLE:

PROPOSED PERSPECTIVE MONTAGE SHEET 4

DRAWN: MB

CHECKED: MB

SCALE: NTS @ A3

DATE: SEPTEMBER_2015

PROJECT NO. 1527

DRAWING NO. A-DA-08 A

VIEW TOWARDS TREVALLYN





REVISION

No	DATE	DESCRIPTION	BY	CHECK
A	16/08/16	DEVELOPMENT APPLICATION	mb	mb

NOTE:
 ALL ERRORS OR ANOMALIES ARE TO BE REPORTED TO HONED ARCHITECTURE + DESIGN.
 DO NOT SCALE OF DRAWINGS.
 CONFIRM ALL SIZES AND HEIGHTS ON SITE.
 ALL CONSTRUCTION IS TO COMPLY WITH BUILDING CODE OF AUSTRALIA AND AUSTRALIAN STANDARDS.
 THESE DOCUMENTS ARE INTENDED FOR COUNCIL PLANNING APPLICATIONS ONLY AND ARE NOT INTENDED FOR ANY OTHER PURPOSE

DEVELOPMENT APPLICATION
 NOT FOR CONSTRUCTION

NOTE: THESE DRAWINGS ARE FOR DEVELOPMENT APPLICATION



PO BOX 147, LAUNCESTON, TASMANIA 7250 Ph: 0417541646
 DIMENSIONS ARE SUBJECT TO SITE MEASUREMENT & VERIFICATION DO NOT SCALE OFF THIS DRAWING ALL DESIGNS ARE COPYRIGHT AND REMAIN PROPERTY OF HONED ARCHITECTURE + DESIGN.

PROJECT NAME:
 POLISH PIONEERS FOUNDATION PUBLIC ART INSTALLATION

DRAWING TITLE:
 PROPOSED PERSPECTIVE MONTAGE SHEET 5

DRAWN: MB
 CHECKED: MB

SCALE: NTS @ A3
 DATE: SEPTEMBER_2015
 PROJECT NO: 1527
 DRAWING NO: A-BA-09 A

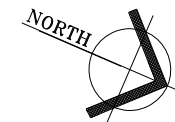

REVISION			
No	DATE	DESCRIPTION	BY CHECK
A	16/08/16	DEVELOPMENT APPLICATION	mb mb

NOTE:
 ALL ERRORS OR ANOMALIES ARE TO BE REPORTED TO HONED ARCHITECTURE + DESIGN
 DO NOT SCALE OF DRAWINGS
 CONFIRM ALL SIZES AND HEIGHTS ON SITE.
 ALL CONSTRUCTION IS TO COMPLY WITH BUILDING CODE OF AUSTRALIA AND AUSTRALIAN STANDARDS.
 THESE DOCUMENTS ARE INTENDED FOR COUNCIL PLANNING APPLICATIONS ONLY AND ARE NOT INTENDED FOR ANY OTHER PURPOSE

DEVELOPMENT APPLICATION
 NOT FOR CONSTRUCTION

NOTE: THESE DRAWINGS ARE FOR DEVELOPMENT APPLICATION



PO BOX 147, LAUNCESTON, TASMANIA 7250 Ph: 0417541646
 DIMENSIONS ARE SUBJECT TO SITE MEASUREMENT & VERIFICATION DO NOT SCALE OFF THIS DRAWING
 ALL DESIGNS ARE COPYRIGHT AND REMAIN PROPERTY OF HONED ARCHITECTURE + DESIGN.

PROJECT NAME:
 POLISH PIONEERS FOUNDATION PUBLIC ART INSTALLATION

DRAWING TITLE:
 PROPOSED PLAN

DRAWN: MB
 CHECKED: MB
 SCALE: 1:100 @ A3
 DATE: SEPTEMBER_2015
 PROJECT NO. 1527
 DRAWING NO. A-DA-10 A

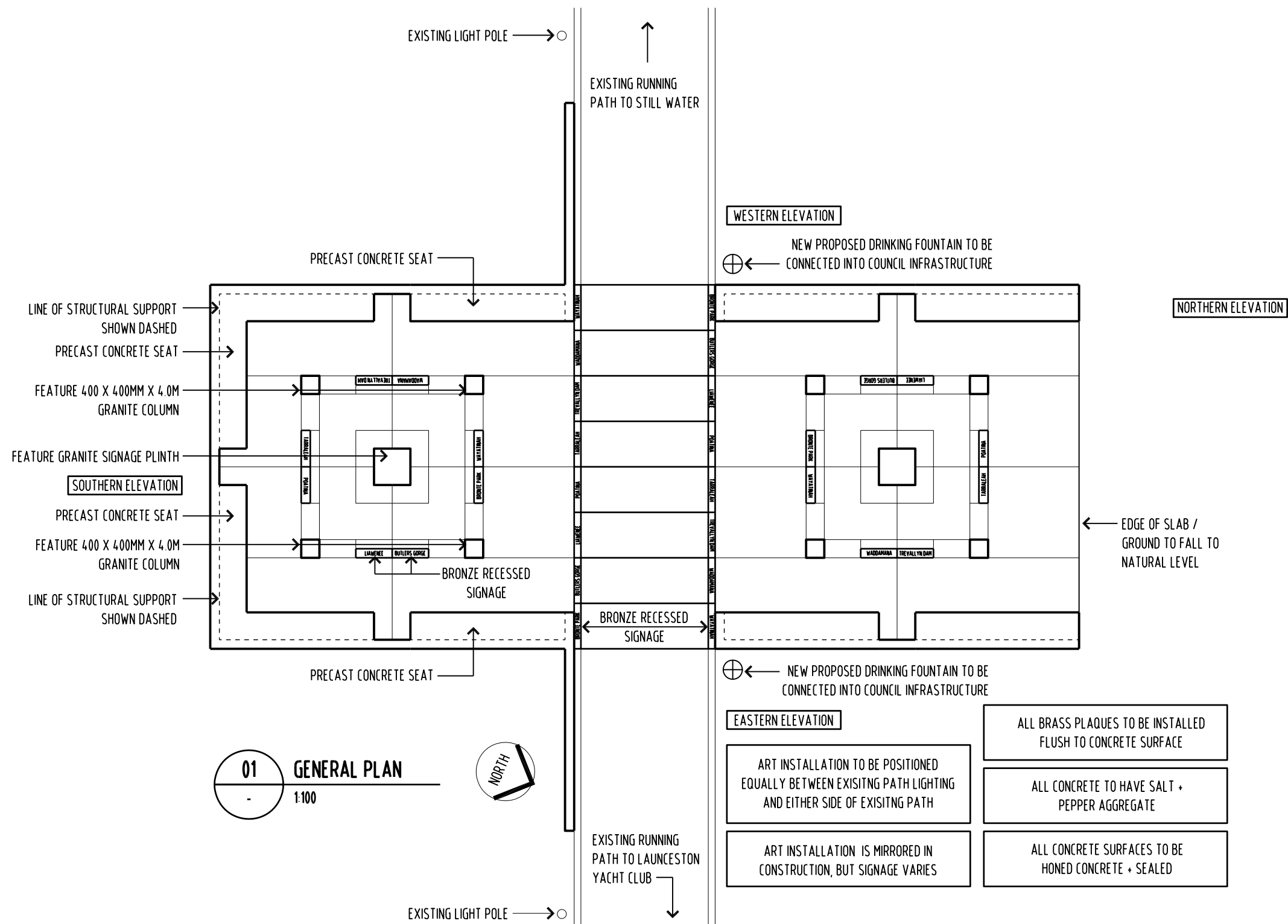

01 GENERAL PLAN
 1:100

- EASTERN ELEVATION**
- ART INSTALLATION TO BE POSITIONED EQUALLY BETWEEN EXISTING PATH LIGHTING AND EITHER SIDE OF EXISTING PATH
 - ART INSTALLATION IS MIRRORED IN CONSTRUCTION, BUT SIGNAGE VARIES
 - ALL BRASS PLAQUES TO BE INSTALLED FLUSH TO CONCRETE SURFACE
 - ALL CONCRETE TO HAVE SALT + PEPPER AGGREGATE
 - ALL CONCRETE SURFACES TO BE HONED CONCRETE + SEALED

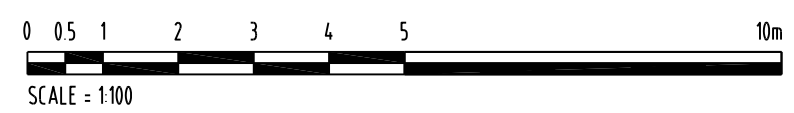



REVISION			
No	DATE	DESCRIPTION	BY CHECK
A	16/08/16	DEVELOPMENT APPLICATION	mb mb

NOTE:
 ALL ERRORS OR ANOMALIES ARE TO BE REPORTED TO HONED ARCHITECTURE + DESIGN.
 DO NOT SCALE OF DRAWINGS.
 CONFIRM ALL SIZES AND HEIGHTS ON SITE.
 ALL CONSTRUCTION IS TO COMPLY WITH BUILDING CODE OF AUSTRALIA AND AUSTRALIAN STANDARDS.
 THESE DOCUMENTS ARE INTENDED FOR COUNCIL PLANNING APPLICATIONS ONLY AND ARE NOT INTENDED FOR ANY OTHER PURPOSE.

DEVELOPMENT APPLICATION
 NOT FOR CONSTRUCTION

NOTE: THESE DRAWINGS ARE FOR DEVELOPMENT APPLICATION



PO BOX 147, LAUNCESTON, TASMANIA 7250 Ph: 0417541646
 DIMENSIONS ARE SUBJECT TO SITE MEASUREMENT & VERIFICATION DO NOT SCALE OFF THIS DRAWING
 ALL DESIGNS ARE COPYRIGHT AND REMAIN PROPERTY OF HONED ARCHITECTURE + DESIGN.

PROJECT NAME:
 POLISH PIONEERS FOUNDATION PUBLIC ART INSTALLATION

DRAWING TITLE:
 PROPOSED SETOUT PLAN

DRAWN: MB
 CHECKED: MB

SCALE: 1:100 @ A3
 DATE: SEPTEMBER_2015

PROJECT NO. 1527
 DRAWING NO. A-DA-11 A

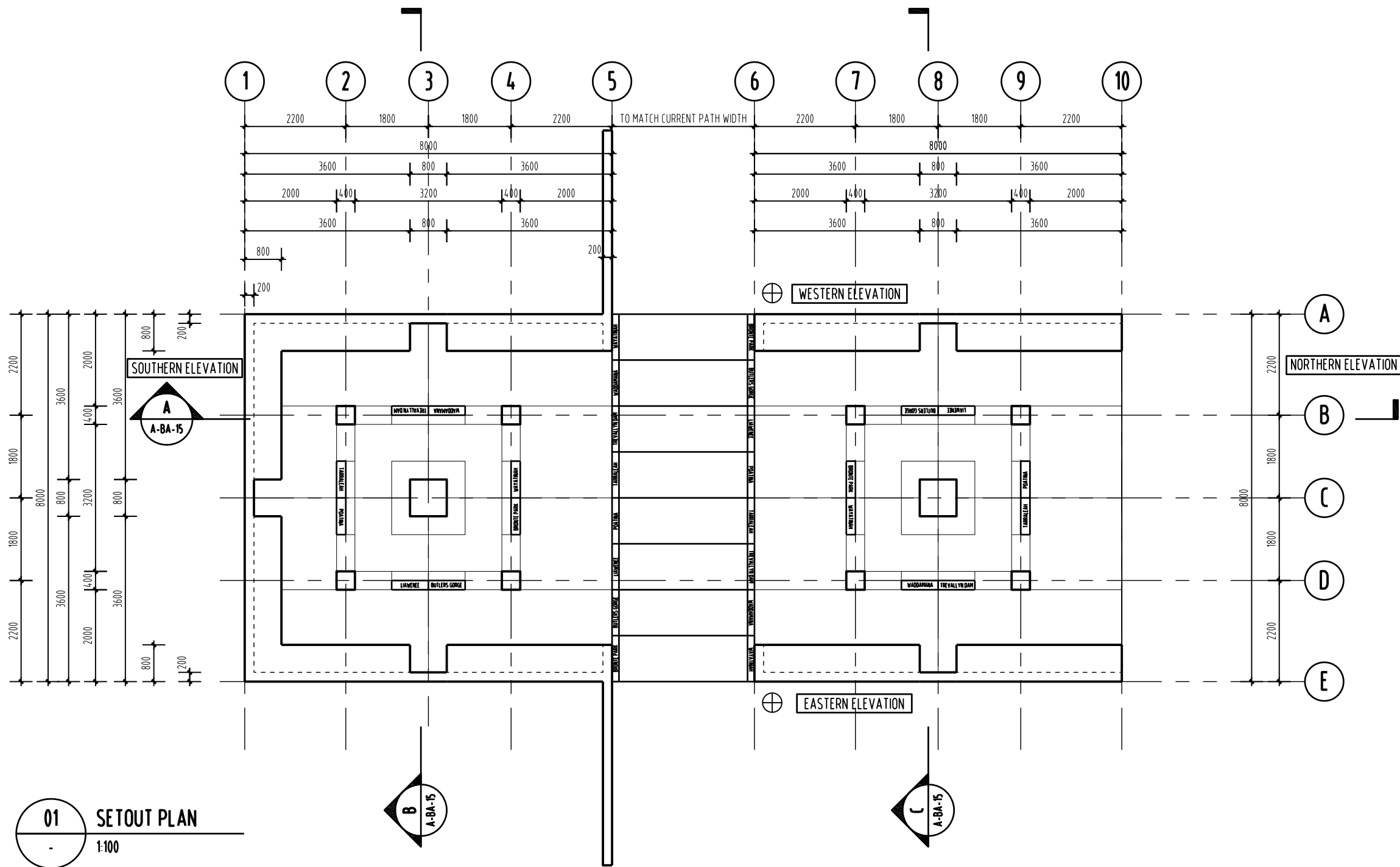

01 SETOUT PLAN
 1:100

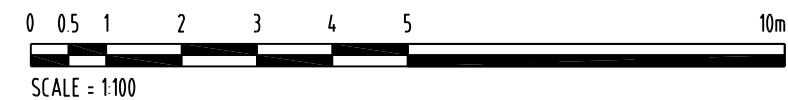



REVISION			
No	DATE	DESCRIPTION	BY CHECK
A	16/08/16	DEVELOPMENT APPLICATION	mb mb

NOTE:
 ALL ERRORS OR ANOMALIES ARE TO BE REPORTED TO HONED ARCHITECTURE + DESIGN.
 DO NOT SCALE OF DRAWINGS.
 CONFIRM ALL SIZES AND HEIGHTS ON SITE.
 ALL CONSTRUCTION IS TO COMPLY WITH BUILDING CODE OF AUSTRALIA AND AUSTRALIAN STANDARDS.
 THESE DOCUMENTS ARE INTENDED FOR COUNCIL PLANNING APPLICATIONS ONLY AND ARE NOT INTENDED FOR ANY OTHER PURPOSE.

DEVELOPMENT APPLICATION
 NOT FOR CONSTRUCTION

NOTE: THESE DRAWINGS ARE FOR DEVELOPMENT APPLICATION



PO BOX 147, LAUNCESTON, TASMANIA 7250 Ph: 0417541646
 DIMENSIONS ARE SUBJECT TO SITE MEASUREMENT & VERIFICATION DO NOT SCALE OFF THIS DRAWING
 ALL DESIGNS ARE COPYRIGHT AND REMAIN PROPERTY OF HONED ARCHITECTURE + DESIGN.

PROJECT NAME:
 POLISH PIONEERS FOUNDATION PUBLIC ART INSTALLATION

DRAWING TITLE:
 PROPOSED CONCRETE CUT LINE PLAN

DRAWN: MB
 CHECKED: MB

SCALE: 1:100 @ A3
 DATE: SEPTEMBER_2015

PROJECT NO. 1527
 DRAWING NO. A-DA-12 A

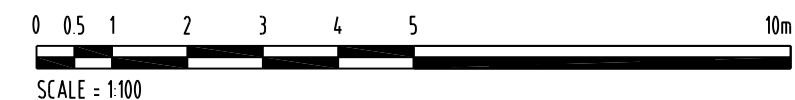
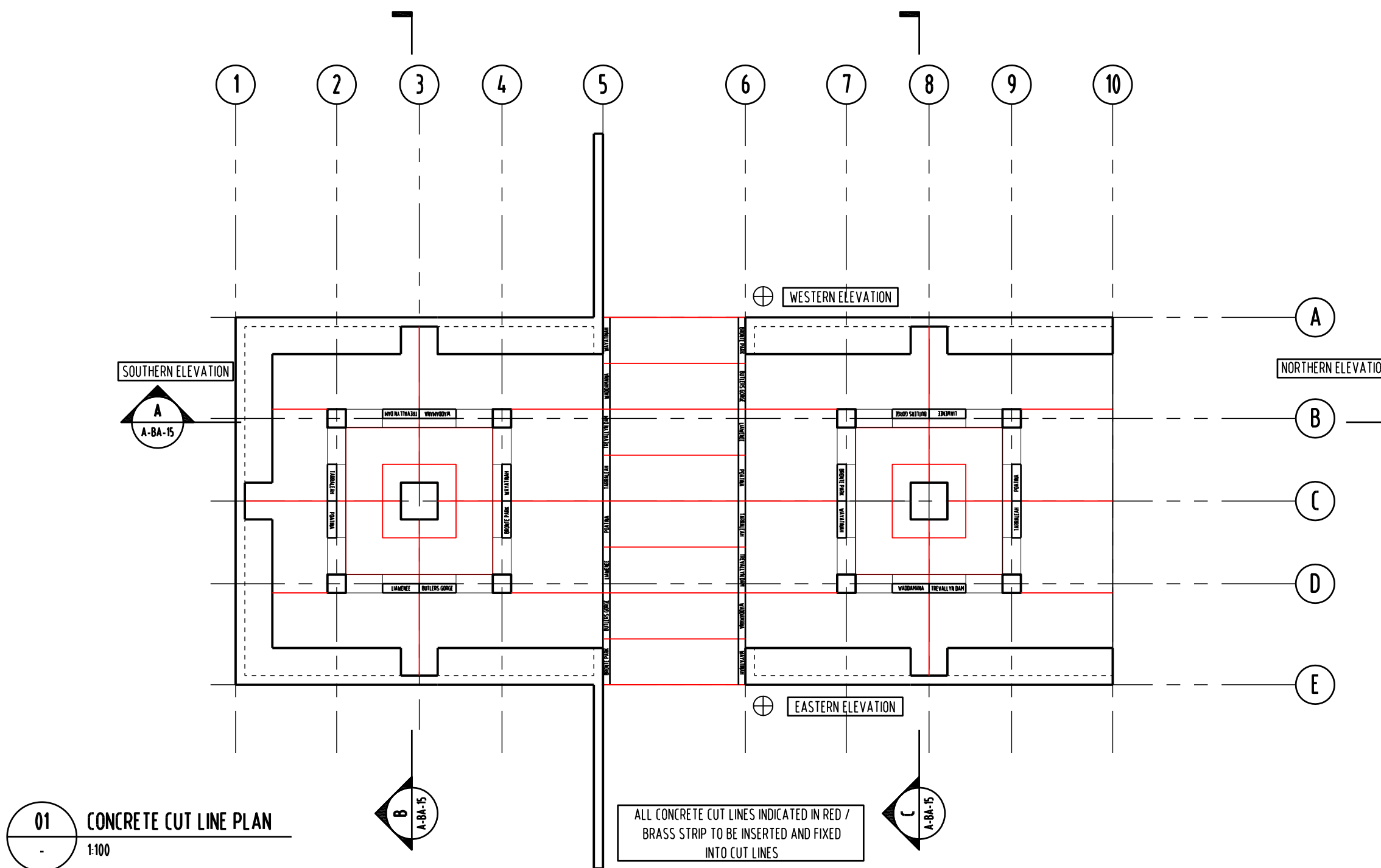

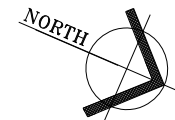

REVISION			
No	DATE	DESCRIPTION	BY CHECK
A	16/08/16	DEVELOPMENT APPLICATION	mb mb

NOTE:
 ALL ERRORS OR ANOMALIES ARE TO BE REPORTED TO HONED ARCHITECTURE + DESIGN.
 DO NOT SCALE OF DRAWINGS.
 CONFIRM ALL SIZES AND HEIGHTS ON SITE.
 ALL CONSTRUCTION IS TO COMPLY WITH BUILDING CODE OF AUSTRALIA AND AUSTRALIAN STANDARDS.
 THESE DOCUMENTS ARE INTENDED FOR COUNCIL PLANNING APPLICATIONS ONLY AND ARE NOT INTENDED FOR ANY OTHER PURPOSE

DEVELOPMENT APPLICATION
 NOT FOR CONSTRUCTION

NOTE: THESE DRAWINGS ARE FOR DEVELOPMENT APPLICATION



PO BOX 147, LAUNCESTON, TASMANIA 7250 Ph: 0417541646
 DIMENSIONS ARE SUBJECT TO SITE MEASUREMENT & VERIFICATION DO NOT SCALE OFF THIS DRAWING
 ALL DESIGNS ARE COPYRIGHT AND REMAIN PROPERTY OF HONED ARCHITECTURE + DESIGN.

PROJECT NAME:
 POLISH PIONEERS FOUNDATION
 PUBLIC ART INSTALLATION

DRAWING TITLE:
 PROPOSED
 FLOOR FINISHES PLAN

DRAWN: MB
 CHECKED: MB
 SCALE: 1:100 @ A3
 DATE: SEPTEMBER_2015
 PROJECT NO. 1527
 DRAWING NO. A-DA-13 A

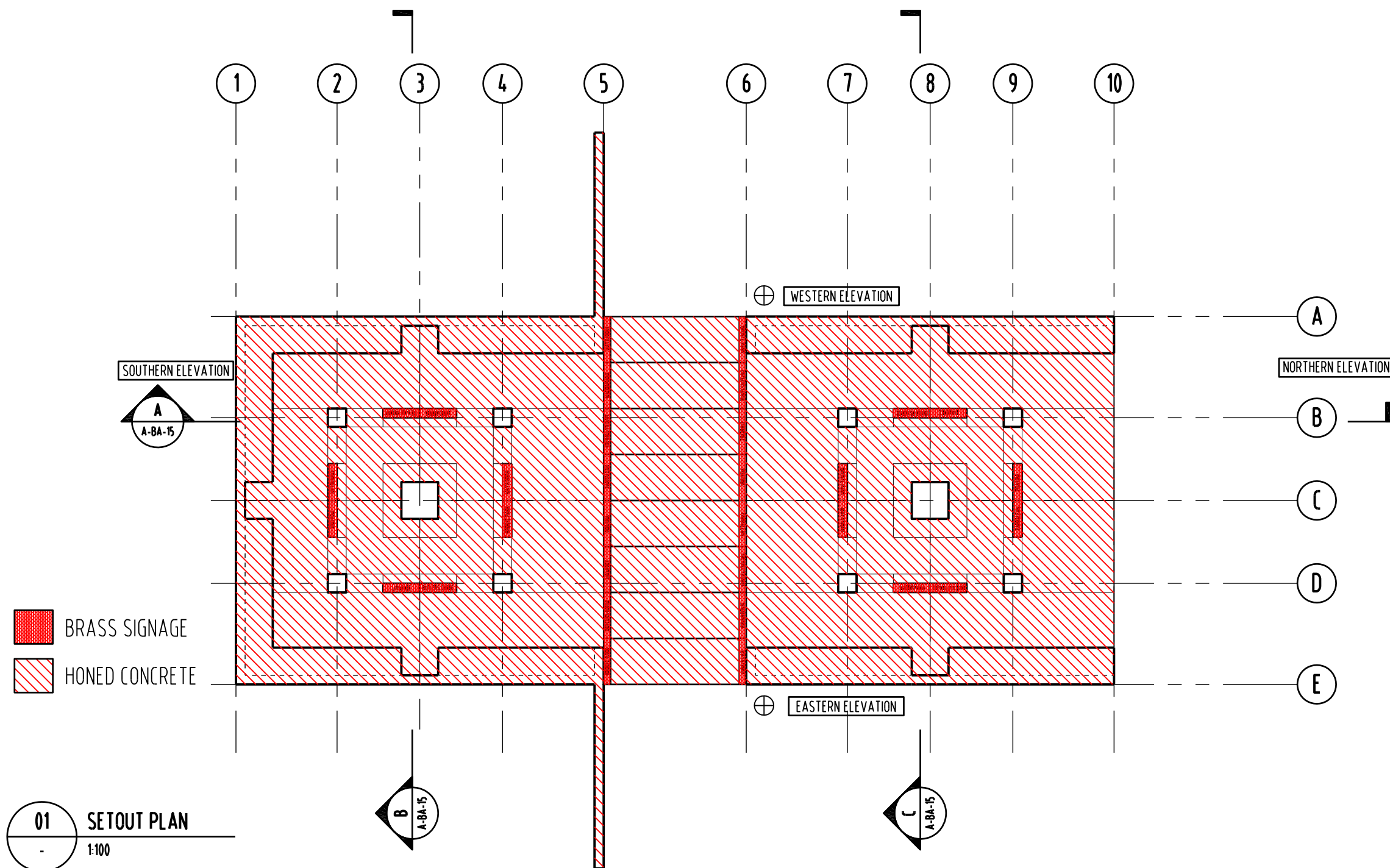

BRASS SIGNAGE
 HONED CONCRETE

01 SETOUT PLAN
 1:100

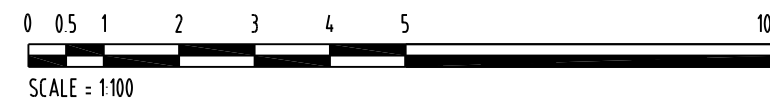



REVISION			
No	DATE	DESCRIPTION	BY CHECK
A	16/08/16	DEVELOPMENT APPLICATION	mb mb

NOTE:
 ALL ERRORS OR ANOMALIES ARE TO BE REPORTED TO HONED ARCHITECTURE + DESIGN.
 DO NOT SCALE OF DRAWINGS.
 CONFIRM ALL SIZES AND HEIGHTS ON SITE.
 ALL CONSTRUCTION IS TO COMPLY WITH BUILDING CODE OF AUSTRALIA AND AUSTRALIAN STANDARDS.
 THESE DOCUMENTS ARE INTENDED FOR COUNCIL PLANNING APPLICATIONS ONLY AND ARE NOT INTENDED FOR ANY OTHER PURPOSE.

DEVELOPMENT APPLICATION
 NOT FOR CONSTRUCTION

NOTE: THESE DRAWINGS ARE FOR DEVELOPMENT APPLICATION



PO BOX 147, LAUNCESTON, TASMANIA 7250 Ph: 0417541646

DIMENSIONS ARE SUBJECT TO SITE MEASUREMENT & VERIFICATION DO NOT SCALE OFF THIS DRAWING
 ALL DESIGNS ARE COPYRIGHT AND REMAIN PROPERTY OF HONED ARCHITECTURE + DESIGN.

PROJECT NAME:
 POLISH PIONEERS FOUNDATION
 PUBLIC ART INSTALLATION

DRAWING TITLE:
 PROPOSED
 ELECTRICAL
 AND PLUMBING PLAN

DRAWN: MB
 CHECKED: MB

SCALE: 1:100 @ A3
 DATE: SEPTEMBER_2015

PROJECT NO. 1527
 DRAWING NO. A-DA-14 A

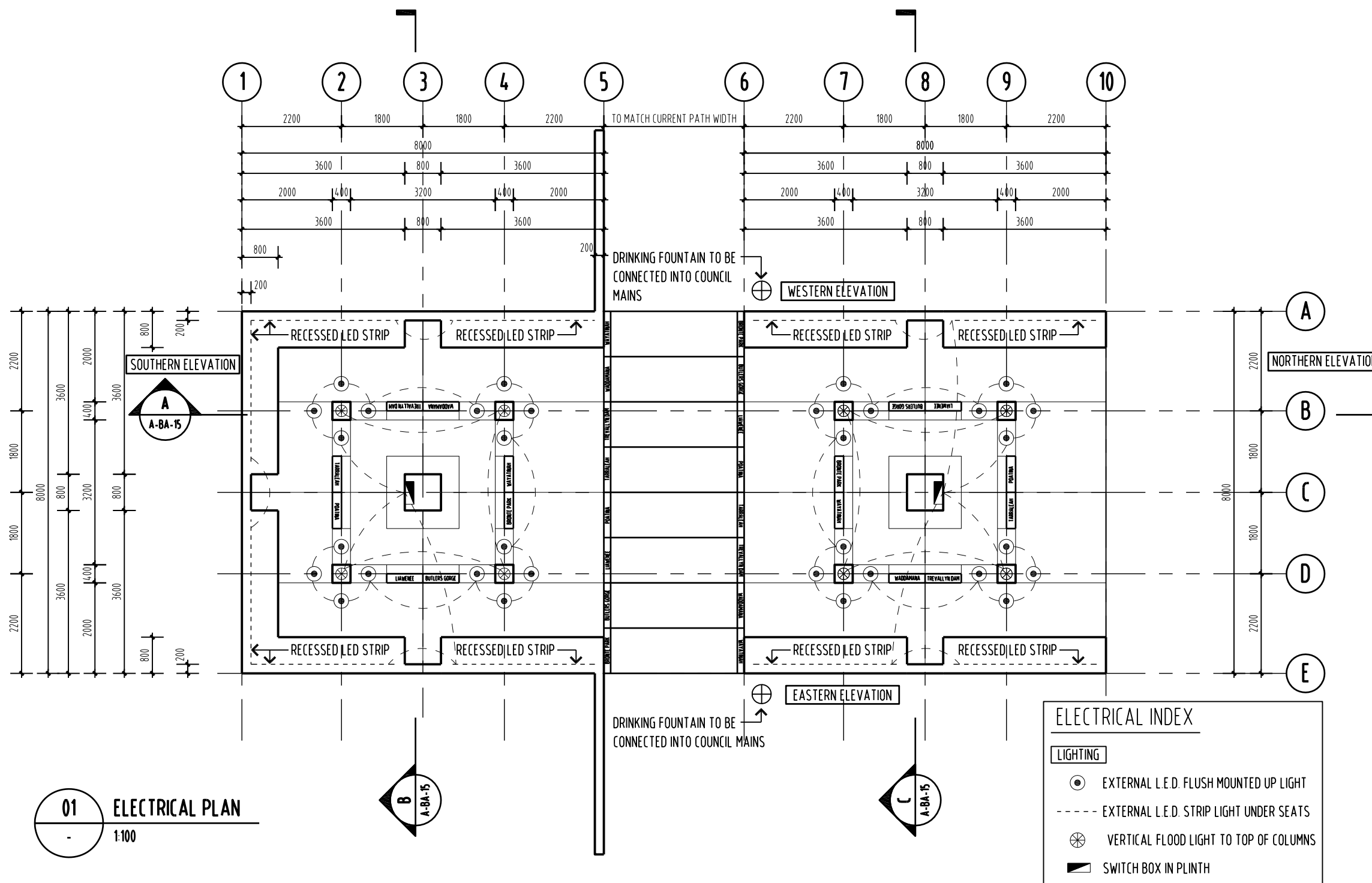

01 ELECTRICAL PLAN
 1:100

ELECTRICAL INDEX

LIGHTING

- EXTERNAL L.E.D. FLUSH MOUNTED UP LIGHT
- EXTERNAL L.E.D. STRIP LIGHT UNDER SEATS
- ⊕ VERTICAL FLOOD LIGHT TO TOP OF COLUMNS
- ▭ SWITCH BOX IN PLINTH

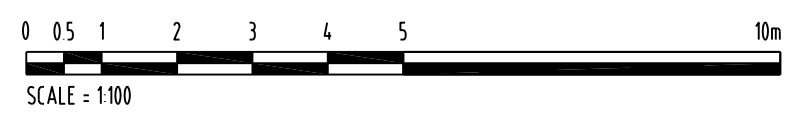

REVISION			
No	DATE	DESCRIPTION	BY CHECK
A	16/08/16	DEVELOPMENT APPLICATION	mb mb

NOTE:
 ALL ERRORS OR ANOMALIES ARE TO BE REPORTED TO HONED ARCHITECTURE + DESIGN
 DO NOT SCALE OF DRAWINGS.
 CONFIRM ALL SIZES AND HEIGHTS ON SITE.
 ALL CONSTRUCTION IS TO COMPLY WITH BUILDING CODE OF AUSTRALIA AND AUSTRALIAN STANDARDS.
 THESE DOCUMENTS ARE INTENDED FOR COUNCIL PLANNING APPLICATIONS ONLY AND ARE NOT INTENDED FOR ANY OTHER PURPOSE

DEVELOPMENT APPLICATION
 NOT FOR CONSTRUCTION

NOTE: THESE DRAWINGS ARE FOR DEVELOPMENT APPLICATION



PO BOX 147, LAUNCESTON, TASMANIA 7250 Ph: 0417541646
 DIMENSIONS ARE SUBJECT TO SITE MEASUREMENT & VERIFICATION DO NOT SCALE OFF THIS DRAWING
 ALL DESIGNS ARE COPYRIGHT AND REMAIN PROPERTY OF HONED ARCHITECTURE + DESIGN.

PROJECT NAME:
 POLISH PIONEERS FOUNDATION PUBLIC ART INSTALLATION

DRAWING TITLE:
 PROPOSED NORTHERN AND EASTERN ELEVATIONS

DRAWN: MB
 CHECKED: MB

SCALE: 1:100 @ A3
 DATE: SEPTEMBER 2015

PROJECT NO. 1527
 DRAWING NO. A-DA-15 A

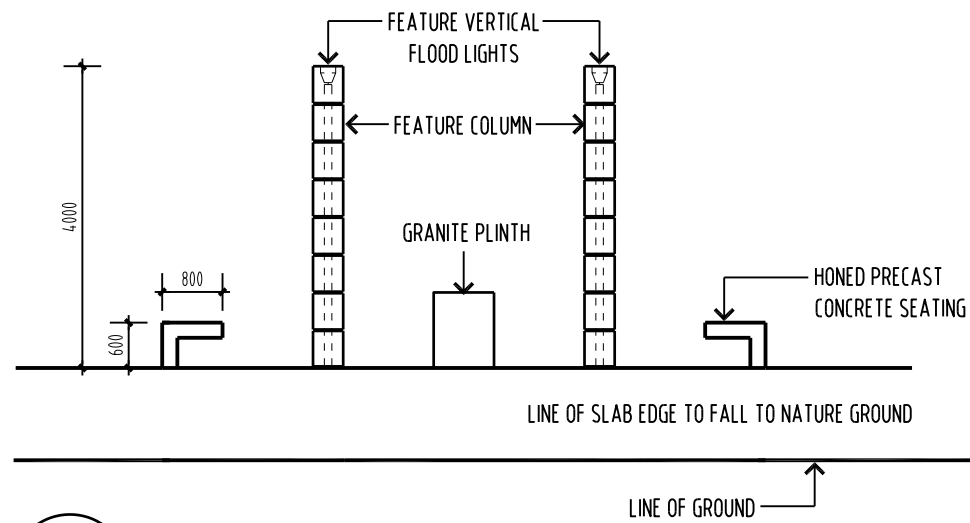

01 NORTHERN ELEVATION
 1:100

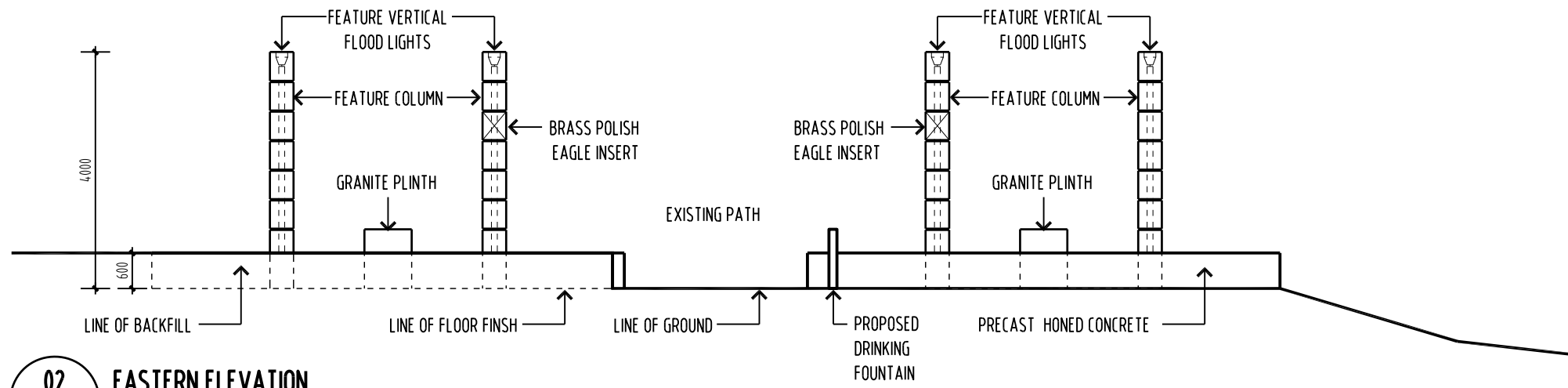

02 EASTERN ELEVATION
 1:100

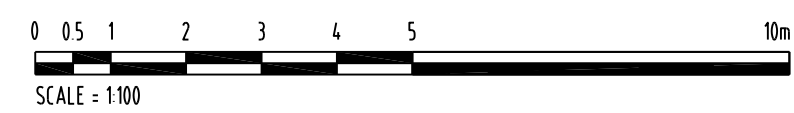

REVISION				
No	DATE	DESCRIPTION	BY	CHECK
A	16/08/16	DEVELOPMENT APPLICATION	mb	mb

NOTE:
 ALL ERRORS OR ANOMALIES ARE TO BE REPORTED TO HONED ARCHITECTURE + DESIGN.
 DO NOT SCALE OF DRAWINGS.
 CONFIRM ALL SIZES AND HEIGHTS ON SITE.
 ALL CONSTRUCTION IS TO COMPLY WITH BUILDING CODE OF AUSTRALIA AND AUSTRALIAN STANDARDS.
 THESE DOCUMENTS ARE INTENDED FOR COUNCIL PLANNING APPLICATIONS ONLY AND ARE NOT INTENDED FOR ANY OTHER PURPOSE

DEVELOPMENT APPLICATION
 NOT FOR CONSTRUCTION

NOTE: THESE DRAWINGS ARE FOR DEVELOPMENT APPLICATION



PO BOX 147, LAUNCESTON, TASMANIA 7250 Ph: 0417541646

DIMENSIONS ARE SUBJECT TO SITE MEASUREMENT & VERIFICATION DO NOT SCALE OFF THIS DRAWING ALL DESIGNS ARE COPYRIGHT AND REMAIN PROPERTY OF HONED ARCHITECTURE + DESIGN.

PROJECT NAME:
 POLISH PIONEERS FOUNDATION PUBLIC ART INSTALLATION

DRAWING TITLE:
 PROPOSED SOUTHERN AND WESTERN ELEVATIONS

DRAWN: MB
 CHECKED: MB

SCALE: 1:100 @ A3
 DATE: SEPTEMBER 2015

PROJECT NO. 1527
 DRAWING NO. A-DA-16 A

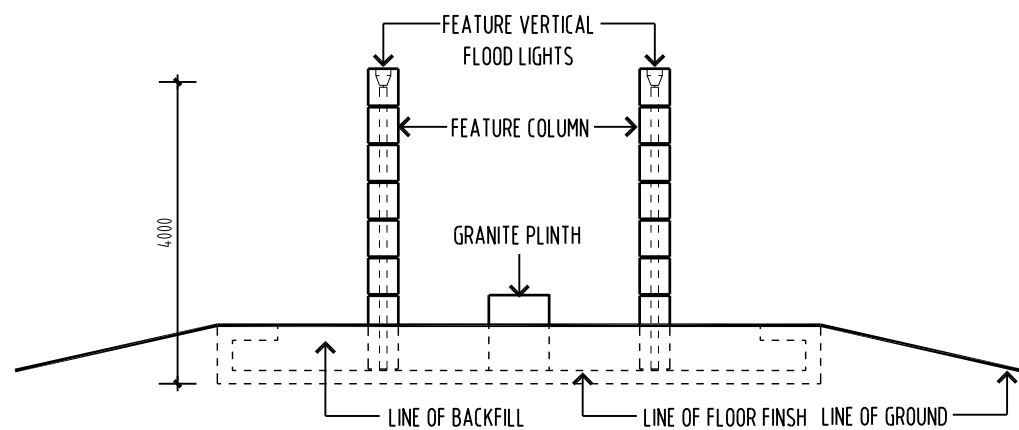

01 SOUTHERN ELEVATION
 - 1:100

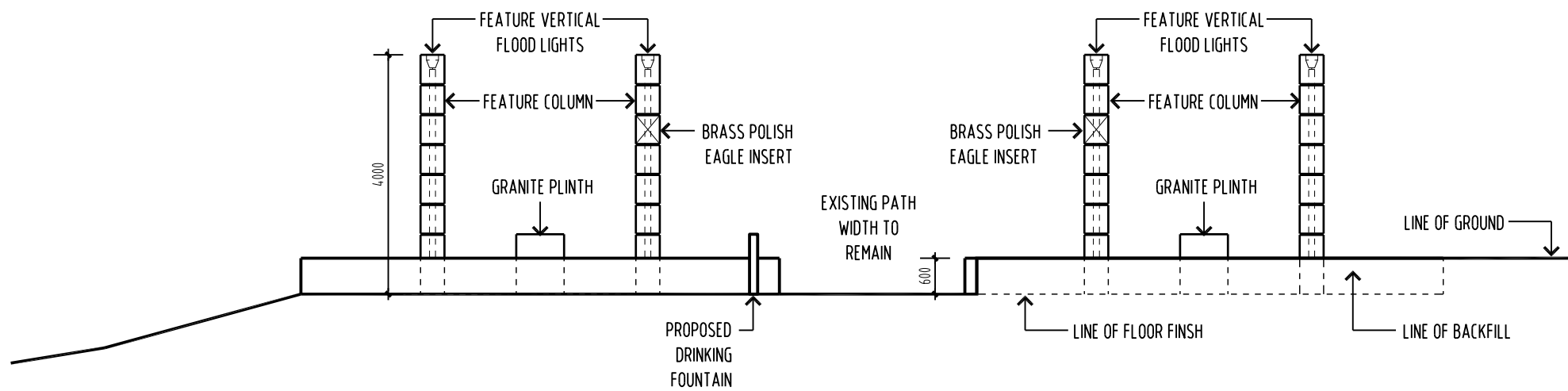

02 WESTERN ELEVATION
 - 1:100

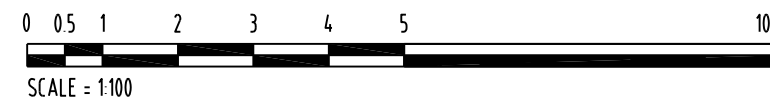

REVISION				
No	DATE	DESCRIPTION	BY	CHECK
A	16/08/16	DEVELOPMENT APPLICATION	mb	mb

NOTE:
 ALL ERRORS OR ANOMALIES ARE TO BE REPORTED TO HONED ARCHITECTURE + DESIGN.
 DO NOT SCALE OF DRAWINGS.
 CONFIRM ALL SIZES AND HEIGHTS ON SITE.
 ALL CONSTRUCTION IS TO COMPLY WITH BUILDING CODE OF AUSTRALIA AND AUSTRALIAN STANDARDS.
 THESE DOCUMENTS ARE INTENDED FOR COUNCIL PLANNING APPLICATIONS ONLY AND ARE NOT INTENDED FOR ANY OTHER PURPOSE.

DEVELOPMENT APPLICATION
 NOT FOR CONSTRUCTION

NOTE: THESE DRAWINGS ARE FOR DEVELOPMENT APPLICATION

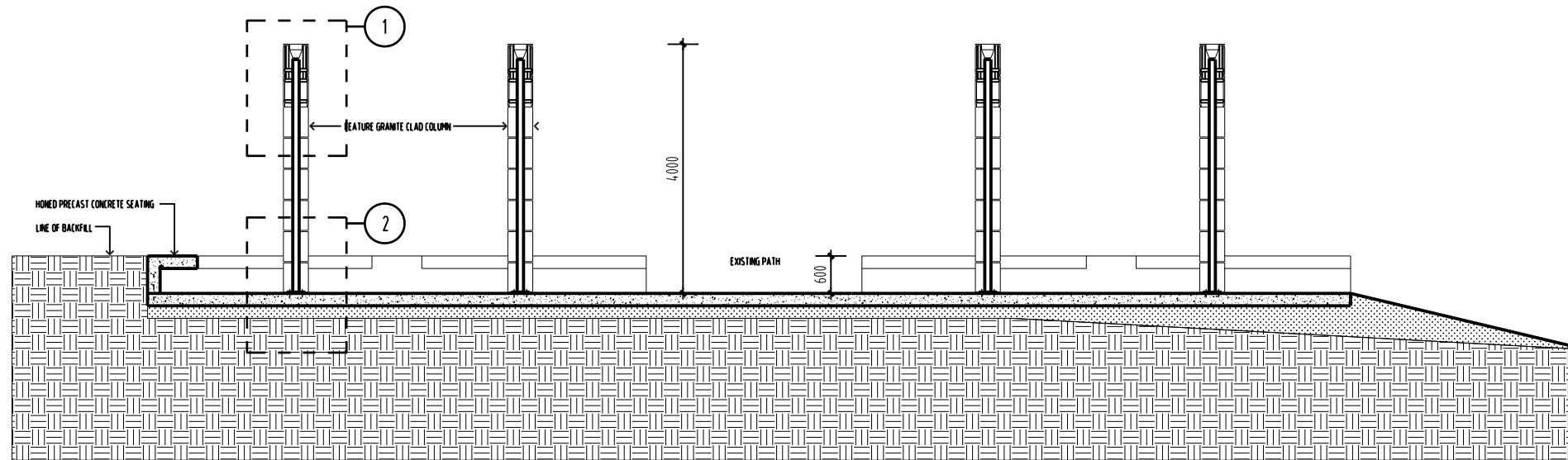

01 SECTION A
 150

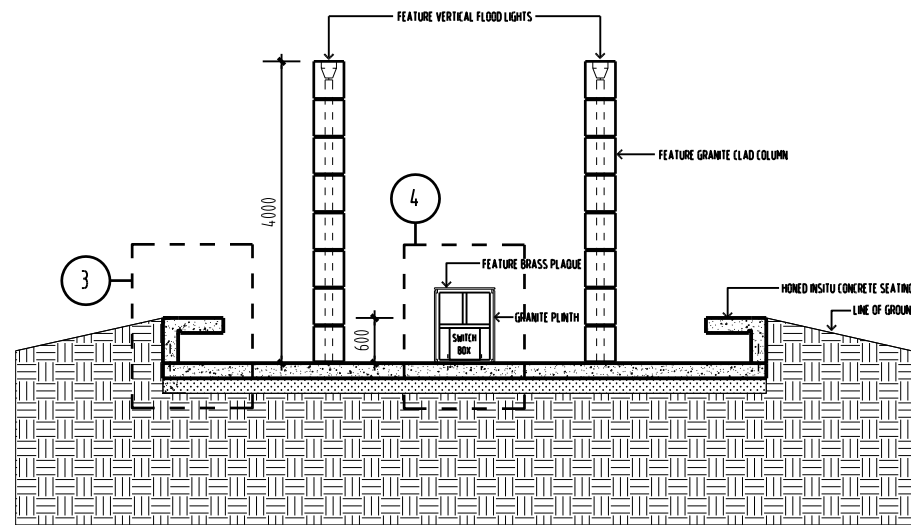

02 SECTION B
 150

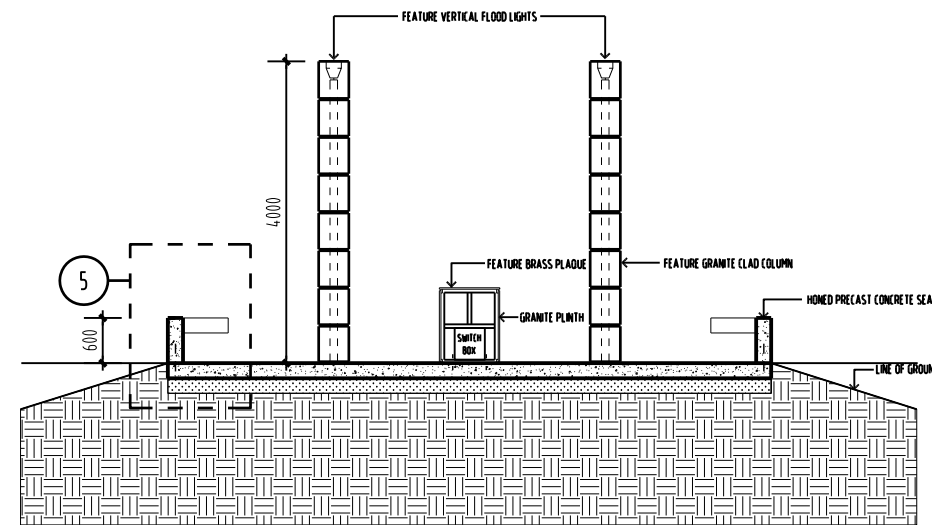

03 SECTION C
 150



PO BOX 147, LAUNCESTON, TASMANIA 7250 Ph: 0417541646
 DIMENSIONS ARE SUBJECT TO SITE MEASUREMENT & VERIFICATION DO NOT SCALE OFF THIS DRAWING
 ALL DESIGNS ARE COPYRIGHT AND REMAIN PROPERTY OF HONED ARCHITECTURE + DESIGN.

PROJECT NAME:
 POLISH PIONEERS FOUNDATION PUBLIC ART INSTALLATION

DRAWING TITLE:
 PROPOSED SECTIONS A-A, B-B & C-C

DRAWN: MB
 CHECKED: MB

SCALE: 1:100 @ A3
 DATE: SEPTEMBER 2015

PROJECT NO. 1527
 DRAWING NO. A-DA-17 A

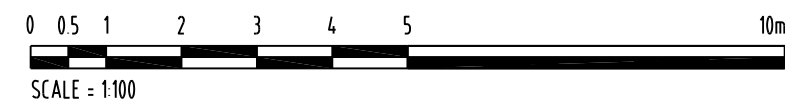

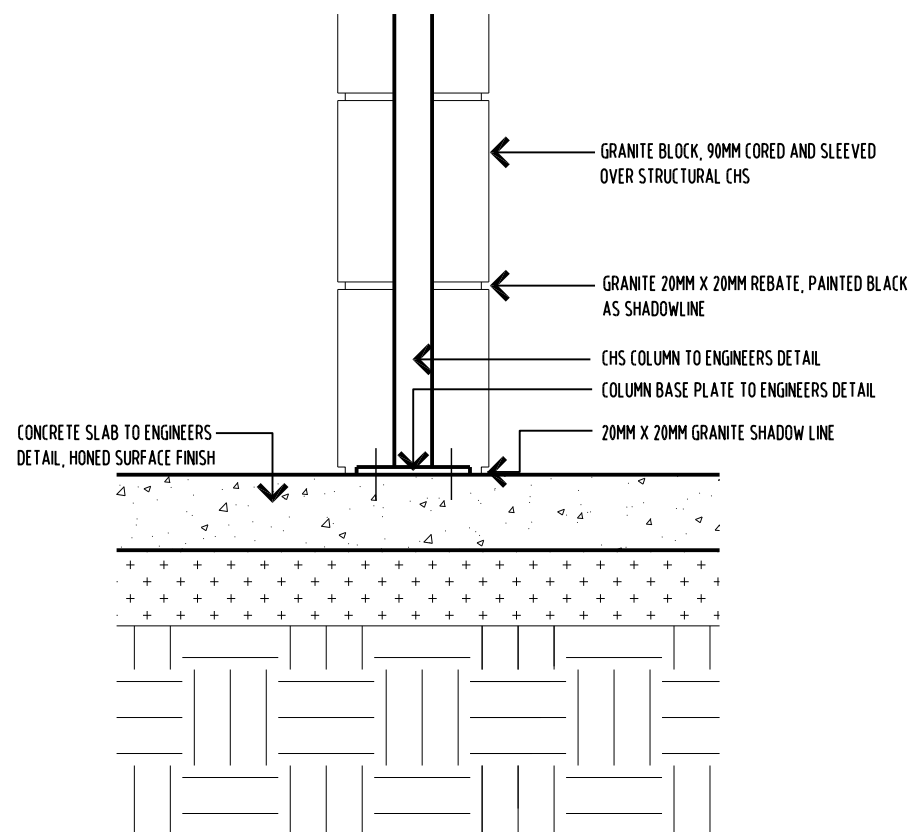
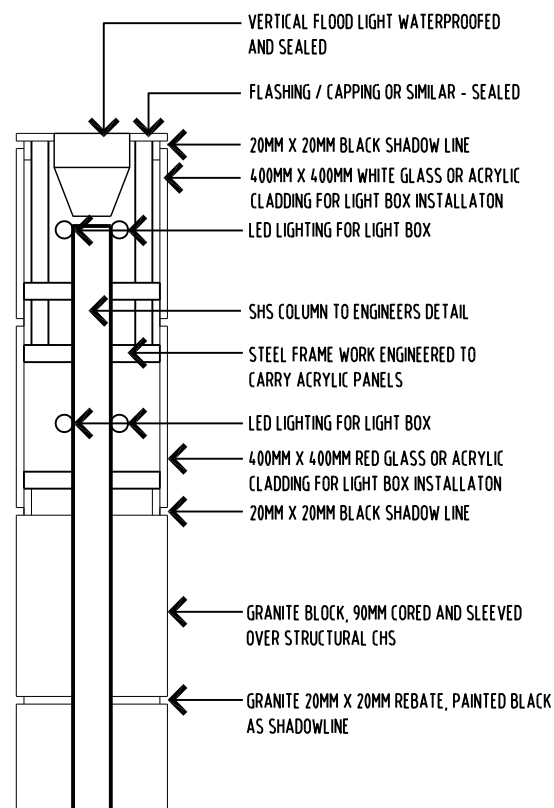

01 DETAIL 1
- 1:20

02 DETAIL 2
- 1:20

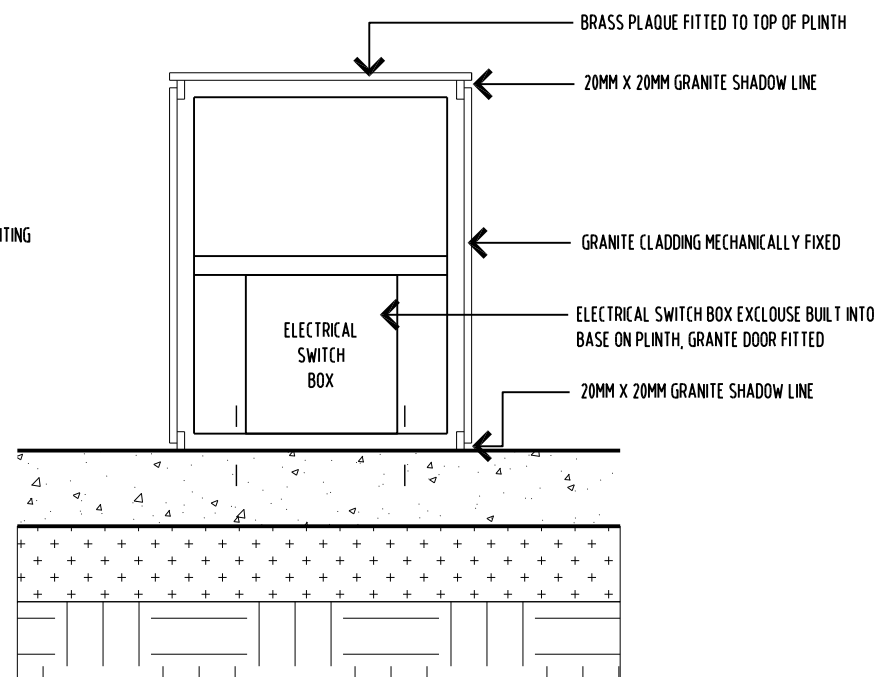
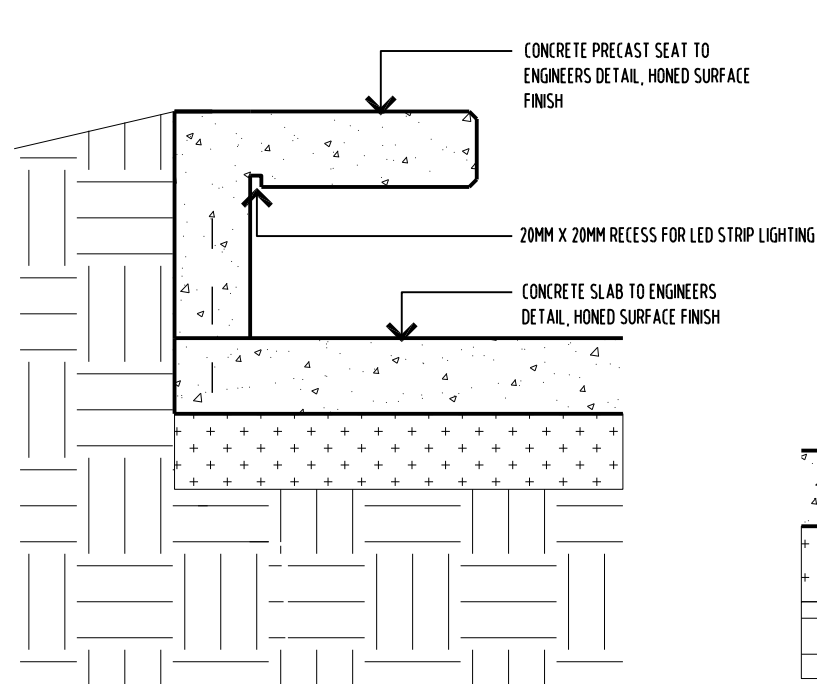

03 DETAIL 3
- 1:20

04 DETAIL 4
- 1:20

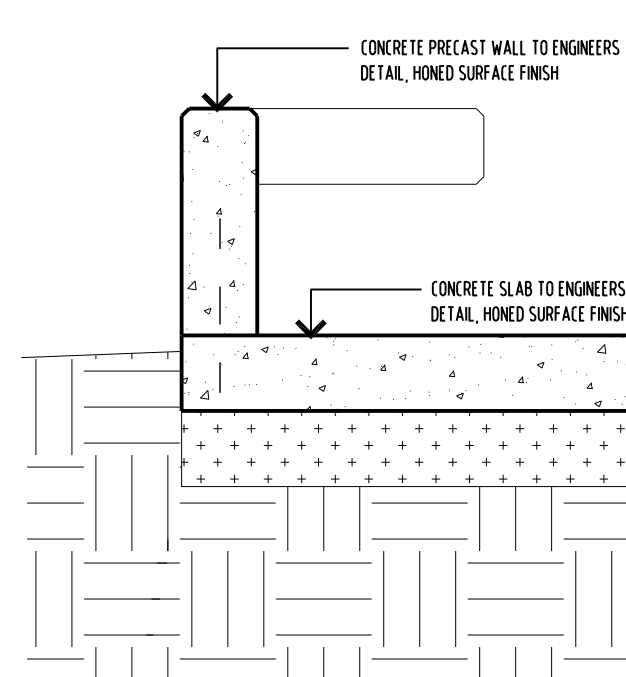

05 DETAIL 5
- 1:20

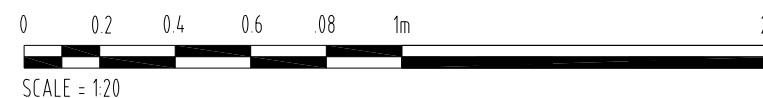

REVISION

No	DATE	DESCRIPTION	BY	CHECK
A	16/08/16	DEVELOPMENT APPLICATION	mb	mb

NOTE:
 ALL ERRORS OR ANOMALIES ARE TO BE REPORTED TO HONED ARCHITECTURE + DESIGN
 DO NOT SCALE OF DRAWINGS
 CONFIRM ALL SIZES AND HEIGHTS ON SITE
 ALL CONSTRUCTION IS TO COMPLY WITH BUILDING CODE OF AUSTRALIA AND AUSTRALIAN STANDARDS.
 THESE DOCUMENTS ARE INTENDED FOR COUNCIL PLANNING APPLICATIONS ONLY AND ARE NOT INTENDED FOR ANY OTHER PURPOSE

DEVELOPMENT APPLICATION
 NOT FOR CONSTRUCTION

NOTE: THESE DRAWINGS ARE FOR DEVELOPMENT APPLICATION



PO BOX 147, LAUNCESTON, TASMANIA 7250 Ph: 0417541646
 DIMENSIONS ARE SUBJECT TO SITE MEASUREMENT & VERIFICATION DO NOT SCALE OFF THIS DRAWING
 ALL DESIGNS ARE COPYRIGHT AND REMAIN PROPERTY OF HONED ARCHITECTURE + DESIGN.

PROJECT NAME:
 POLISH PIONEERS FOUNDATION PUBLIC ART INSTALLATION

DRAWING TITLE:
 PROPOSED DETAILS 1,2,3,4 & 5

DRAWN: MB
 CHECKED: MB
 SCALE: 1:20 @ A3
 DATE: SEPTEMBER_2015
 PROJECT NO. 1527
 DRAWING NO. A-DA-18 A

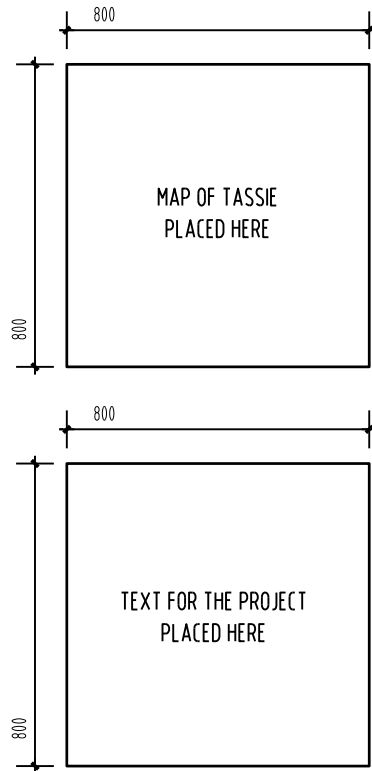
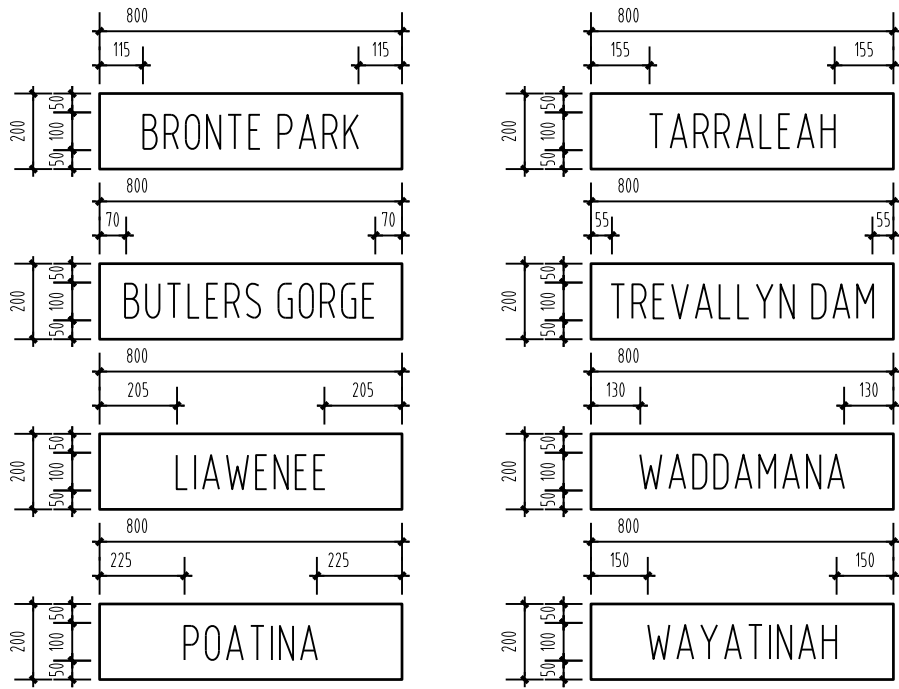

SIGNAGE BETWEEN COLUMNS, INSERTED, FLUSH FINISH TO SLAB SURFACE - TWO OF EACH

PLINTH SIGNAGE, FACE OUNTED TO GRANITE - ONE OF EACH

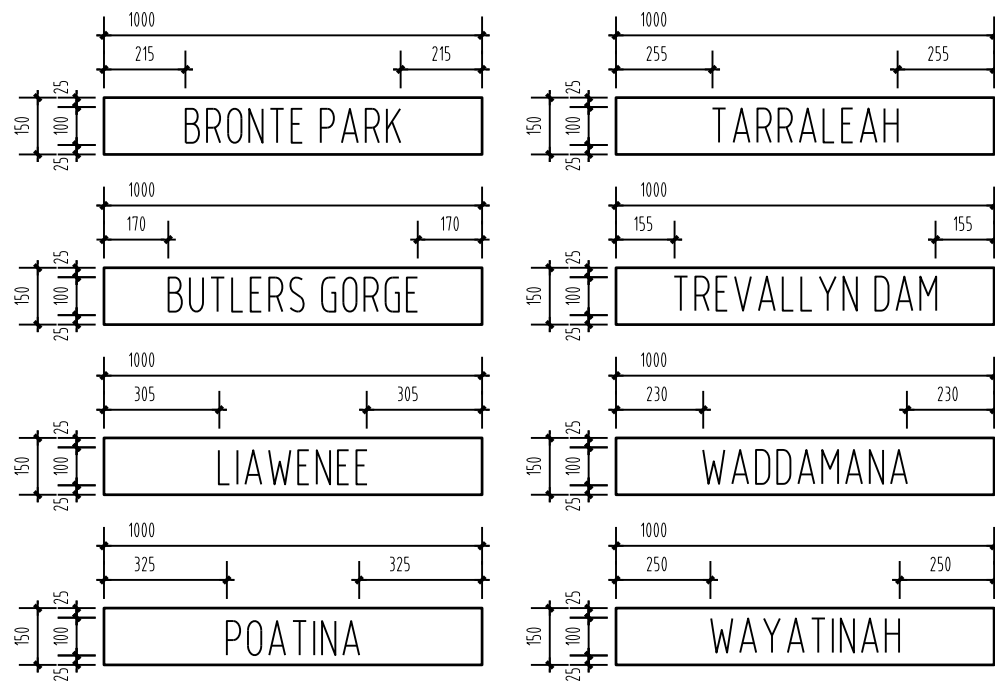
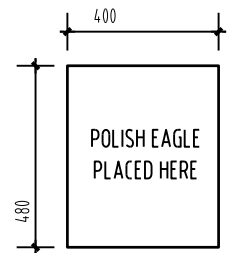

COLUMN SIGNAGE, FACE MOUNTED TO GRANITE - FOUR OF EACH

PATHWAY SIGNAGE, INSERTED, FLUSH FINISH TO SLAB SURFACE - TWO OF EACH



POLISH EAGLE EXAMPLE FOR SIGNAGE

- NOTE:
- ALL SIGNAGE PLAQUES, POLISH EAGLES AND TEXT TO BE IN TRADITIONAL CAST BRONZE.
 - ALL CONCRETE SAW CUT INSERT STRIPS TO BE IN BRASS PLATE
 - SIGNAGE AND TEXT FOR PLINTHS TO BE CONFIRMED AT LATER STAGE. MAKE PROVISIONAL SUMS ALLOWANCE.

REVISION				
No	DATE	DESCRIPTION	BY	CHECK
A	16/08/16	DEVELOPMENT APPLICATION	mb	mb

NOTE:

ALL ERRORS OR ANOMALIES ARE TO BE REPORTED TO HONED ARCHITECTURE + DESIGN.

DO NOT SCALE OF DRAWINGS.

CONFIRM ALL SIZES AND HEIGHTS ON SITE.

ALL CONSTRUCTION IS TO COMPLY WITH BUILDING CODE OF AUSTRALIA AND AUSTRALIAN STANDARDS.

THESE DOCUMENTS ARE INTENDED FOR COUNCIL PLANNING APPLICATIONS ONLY AND ARE NOT INTENDED FOR ANY OTHER PURPOSE.

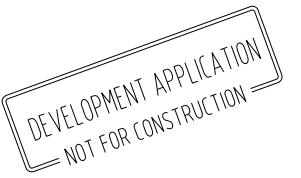

NOTE: THESE DRAWINGS ARE FOR DEVELOPMENT APPLICATION



PO BOX 147, LAUNCESTON, TASMANIA 7250 Ph: 0417541646

DIMENSIONS ARE SUBJECT TO SITE MEASUREMENT & VERIFICATION DO NOT SCALE OFF THIS DRAWING

ALL DESIGNS ARE COPYRIGHT AND REMAIN PROPERTY OF HONED ARCHITECTURE + DESIGN.

PROJECT NAME:
POLISH PIONEERS FOUNDATION PUBLIC ART INSTALLATION

DRAWING TITLE:
SIGNAGE PACKAGE

DRAWN: MB
CHECKED: MB

SCALE: 120 @ A3
DATE: SEPTEMBER 2015

PROJECT NO. 1527
DRAWING NO. A-DA-19 A