

Existing Site Plan

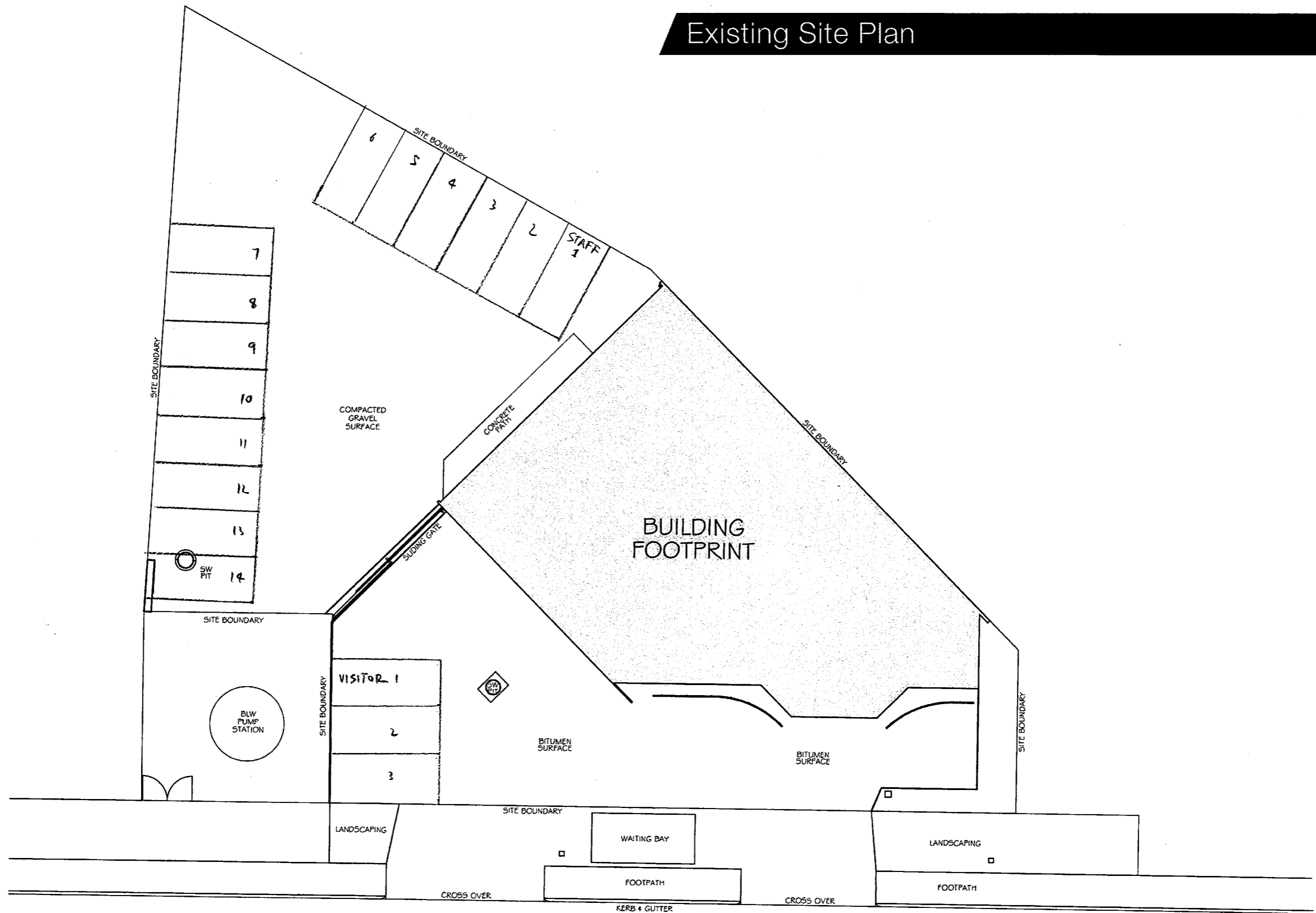

AREAS
SITE 994 m ²

Existing Site Plan
Scale 1:200

CBM Sustainable Design

LTN: 8 Broadland Drive, PO Box 1971, Launceston TAS 7250
 HBT: 160 Bungana Way, Cambridge, TAS 7170
 VIC: Level 7, 533 Little Lonsdale Street, Melbourne, VIC 3000
 NSW: Impact Centre, 19 Chetwynd Road, Enna, NSW 2250
 P: (03) 6332 6988 F: (03) 6331 8300 E: info@cbmgroup.com.au

BROADLAND DRIVE

8 Broadland Drive
Launceston TAS 7250

#REVISION 1
8th DC 2015

SKETCH DESIGN SUBJECT TO STATUTORY APPROVAL. COPYRIGHT 2015 ©



www.cbmsustainabledesign.com.au