

BUILDING ENVELOPE & THEIR LOCATIONS ARE SUBJECT TO A PART V AGREEMENT WITH COUNCIL AND FINAL SURVEY.

- Notes:
1. HORIZONTAL DATUM PLANE BASED ON SPM10631.
 2. VERTICAL DATUM AHD BASED ON SPM10631.
 3. ALL DIMENSIONS AND AREAS ARE SUBJECT TO SURVEY.
 4. THIS PLAN WAS PREPARED AS A PROPOSAL PLAN TO ACCOMPANY A DEVELOPMENT APPLICATION TO COUNCIL AND SHOULD NOT BE USED FOR ANY OTHER PURPOSE.
 5. CONTOUR INTERVAL - 1.0m
CONTOUR INDEX INTERVAL - 5.0m

PROPOSAL PLAN
2 LOT SUBDIVISION
LOT 300 - C.T. 167726-300
OWNER: MIRANDA (TRUFFERIE) PASTORAL CO



10 Goodman Court Invermay TAS 7248
PO Box 593 Mowbray Heights TAS 7248
Phone (03) 6332 3760
Fax (03) 6332 3764
Email: admin@woolcottsurveys.com.au

Job Number
2014-139

Drawn BRW	File name 2014-139_PROPOSALPLAN_210415.DWG	Date 21/04/15	Scale 1:1000@A3	Edition 2.0	Sheet 1 OF 1
--------------	---	------------------	--------------------	----------------	-----------------

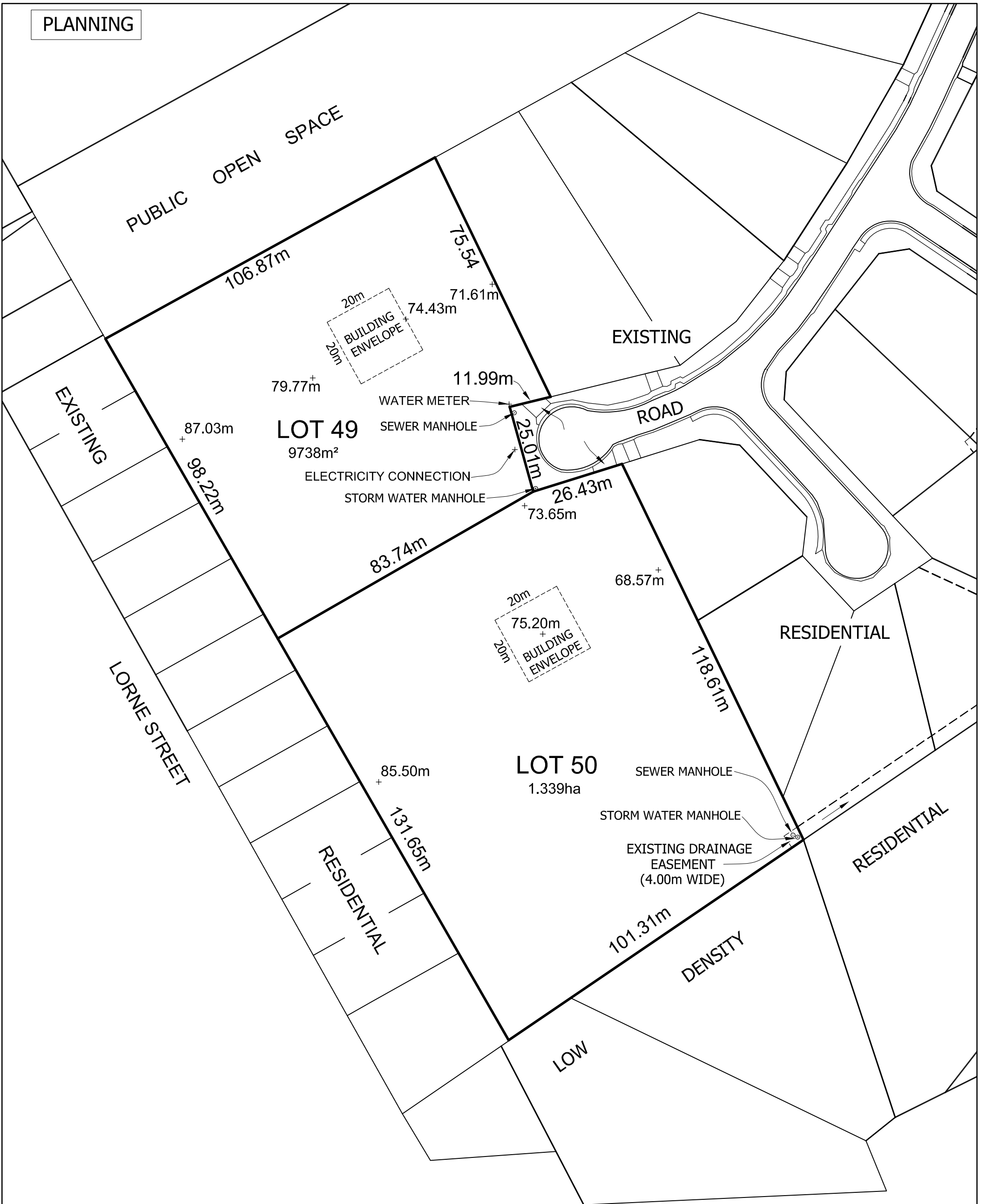

20m X 20m BUILDING ENVELOPE LOCATIONS ARE SUBJECT TO A PART V AGREEMENT WITH COUNCIL AND SURVEY.

- Notes:
1. HORIZONTAL DATUM PLANE BASED ON SPM10631.
 2. VERTICAL DATUM AHD BASED ON SPM10631.
 3. ALL DIMENSIONS AND AREAS ARE SUBJECT TO SURVEY.
 4. THIS PLAN WAS PREPARED AS A PROPOSAL PLAN TO ACCOMPANY A DEVELOPMENT APPLICATION TO COUNCIL AND SHOULD NOT BE USED FOR ANY OTHER PURPOSE.

PROPOSAL PLAN
2 LOT SUBDIVISION
 LOT 300 - C.T. 167726-300
 OWNER: MIRANDA (TRUFFERIE) PASTORAL CO



WOOLCOTT SURVEYS

10 Goodman Court Invermay TAS 7248
 PO Box 593 Mowbray Heights TAS 7248
 Phone (03) 6332 3760
 Fax (03) 6332 3764
 Email: admin@woolcottsurveys.com.au

Job Number
 2014-139

Drawn MBR	File name 2014-139_PROPOSALPLAN_070714.DWG	Date 07/07/14	Scale 1:1000@A3	Edition 1	Sheet 10F1
--------------	---	------------------	--------------------	--------------	---------------

PLANNING



BUILDING ENVELOPE & THEIR LOCATIONS ARE SUBJECT TO A PART V AGREEMENT WITH COUNCIL AND FINAL SURVEY.

- Notes:
1. HORIZONTAL DATUM PLANE BASED ON SPM10631.
 2. VERTICAL DATUM AHD BASED ON SPM10631.
 3. ALL DIMENSIONS AND AREAS ARE SUBJECT TO SURVEY.
 4. THIS PLAN WAS PREPARED AS A PROPOSAL PLAN TO ACCOMPANY A DEVELOPMENT APPLICATION TO COUNCIL AND SHOULD NOT BE USED FOR ANY OTHER PURPOSE.
 5. CONTOUR INTERVAL - 1.0m
CONTOUR INDEX INTERVAL - 5.0m

PROPOSAL PLAN
2 LOT SUBDIVISION
 LOT 300 - C.T. 167726-300
 OWNER: MIRANDA (TRUFFERIE) PASTORAL CO



10 Goodman Court Invermay TAS 7248
 PO Box 593 Mowbray Heights TAS 7248
 Phone (03) 6332 3760
 Fax (03) 6332 3764
 Email: admin@woolcottsurveys.com.au

Job Number
 2014-139

Drawn	File name	Date	Scale	Edition	Sheet
BRW	2014-139_PROPOSALPLAN_210415.DWG	21/04/15	1:1000@A3	2.0	1 OF 1

File No: DA0199/2015
SS

Your Ref:

12 May 2015

Graeme Walkem
Miranda (Trufferie) Pastoral Company Pty Ltd
PO Box 1630
LAUNCESTON TAS 7250

Dear Graeme

General Manager's advice in relation to capacity of public stormwater system required by Planning Scheme

In accordance with the requirements of Launceston Interim Planning Scheme 2015, Clause 12.4.7 Discharge of Stormwater (Low Density Residential zone) I advise in relation to Acceptable Solution A2 that:

- The public stormwater system has the capacity to accommodate the stormwater discharge from the subdivision.

Please contact the Roads and Hydraulics Department on 6323 3331 if you require additional information in relation to this matter,

Yours sincerely



Robert Dobrzynski
GENERAL MANAGER

CC: Julia Allen - Town Planner, City of Launceston